

WALL MOUNTING LANDSCAPE LIGHT

PROJECT DATA

Assigned code :

Project : Location :

Approved by : Date :



MODEL: MS7EH0274-2x30W

Introduction

Wall mounting landscape light is the surface mounting luminaire for indoor/outdoor use. The manufacture process is extremely strict, high quality output with CE, ROHS certified. Its excellent light brings comfort and good experience to the users.

Feature

- Housing extruded aluminum alloy #6063 with anti-corrosion powder coating T=60-80μm, adhesion of ISO class 1/ ASTM class 4B.
- Optics reflector efficiency ≥85%.
- Use LED brand NICHIA.
- Power cable outside of luminaire H05RN-F 2x1.0mm², L=0.3m(DC24V), H05RN-F 3x1.0mm², L=0.3m (AC120/240V).
- Warranty 3 year.

Application area

- Applied to facade of building, hotel, resort and etc.

Mounting type

- Surface mounting.

Approval and marking



Product color



Dimension: (mm)

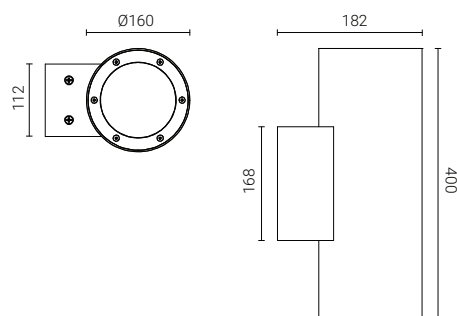

Feature



Beam angle



Technical information

• Model	: MS7EH0274-2x30W
• Led chip	: LED COB NICHIA
• Rated power	: 2x30W
• Luminous flux	: 2x3400lm(cool white), 2x3177lm(warm white)
• Luminous efficacy	: 2x113.3lm/W(cool white), 105.9lm/W(warm white)
• Input voltage	: DC24V/AC120V
• Color temperature	: 2700K/3000K/4000K/5700K/6500K
• Beam angle	: 25°
• Control method	: On/off
• Protection grade	: IP65
• IK rating	: IK06
• Operating temperature	: -20°C~40°C
• Product life	: 35000 hours

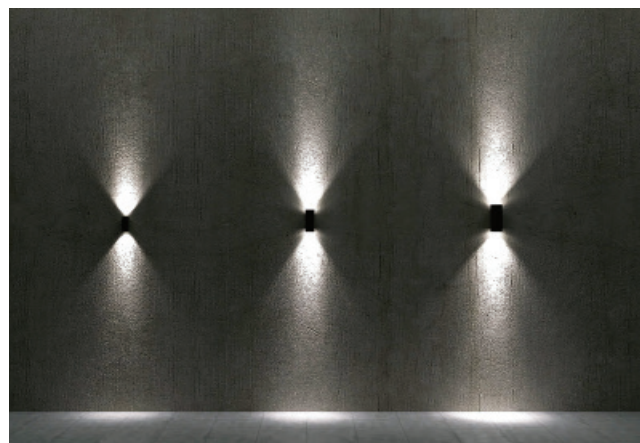

We reserve the right to make technical and design changes.

THIEN MINH MECHANICAL - ELECTRIC JSC

Head office: MESTAR Building, No. 98/11 Ung Van Khiem Street, Ward 25, Binh Thanh District, Ho Chi Minh City, Vietnam

Tel: (84) 28.3899 4790 - Email: mestar@mestar.vn - Web: www.mestar.vn

