



MATRIX 2

FLOODLIGHTS AND PROJECTORS



MATRIX 2



Introduction

Square surface architectural floodlight series, adopt isolate structure to fully ensure the stability and long lifespan of LED light. With multiway rotate function of u-shaped bracket, spike, tension clip mounting are available to meet various occasions demands for outdoor projects.

Features

- High pressure die-casting aluminum housing.
- High strength toughened glass.
- Surface finish with fluorine carbon spraying ensuring high corrosion resistance, resist the impact and friction.
- LED module: high-power LEDs on metal-core PCB.
- High-efficiency PMMA lens with various beam angle option.
- Zoomable beam angle function option with photoelectron zoom technology.
- Adopt American CREE original LED light source, high flux output, excellent consistency of color.
- Constant current AC100-240, driver with On/Off, DALI, 0-10V control method or DC24V, DC36V input voltage with DMX512 control method.
- Single color with various temperature option: 2700K/3000K/4000K/5000K/6000K.
- Dynamic color with RGBW option have gray level reach 65,536 degree equally make the light result is more beautiful.
- Powerful DMX512 interface adopt high reliable bus connect, all has the function of automatic addressing.

Applications areas

- Facade of outdoor buildings, billboards, sculptures etc.

Mounting type

- Surface mounting, spike, c clip type etc.

Approvals and markings



Feature



Beam angle

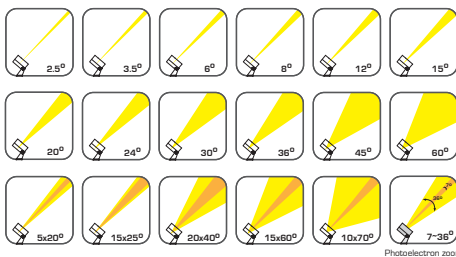

Color temperature

- | | |
|---------------|----------------|
| Single | Dynamic |
| • 2700K | • RGBW |
| • 3000K | |
| • 4000K | |
| • 5000K | |
| • 6000K | |

Product colour



Dimension (mm):

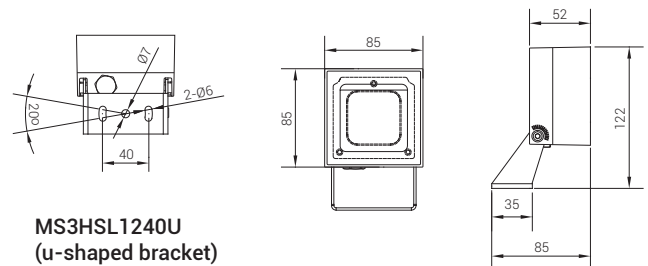

MATRIX 2**Variants**

MS3HMX1240C
(Tension clip C type)

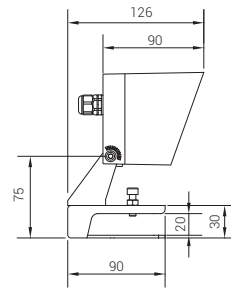
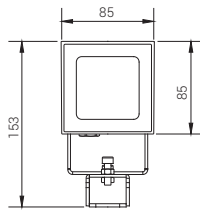

MS3HMX1240S
(Ground spike)

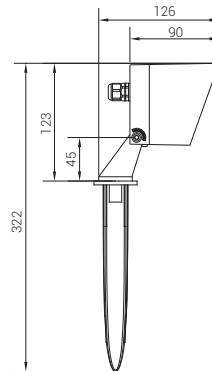
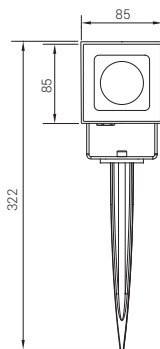

MATRIX 2

Specification

Model	MS3HMX1240UE-10W	MS3HMX1240UF-8W	MS3HMX1240UB-10W
Led brand	CREE / OSRAM	CREE RGBW 4in1	OSRAM
Led quantity	1pc	1pc	4pcs
Rated power	10W	8W	10W
Lumen	650lm (±10%)	320lm (±10%)	650lm (±10%)
Input voltage	AC100-264V	DC24V	DC12V/AC100-240V
Frequency range	50/60Hz	/	50/60Hz
Color temperature	Single	RGBW	Single
Beam angle	2.5° 3.5° 8° 12° 20° 30° 45° 60° 10x70° 5x20°	8° 15° 20° 30° 15x60°	6° 15° 20° 30° 45° 20x40° 15x25°
Control method	On/Off, DALi, 0-10V	DMX512	On/Off, DALi, 0-10V
Protection grade	IP66	IP66	IP66
Ambient temperature	-25°C~50°C	-25°C~50°C	-25°C~50°C
Ambient humidity	10%~90%	10%~90%	10%~90%
Product life	50000H	50000H	50000H

Model	MS3HMX1240UZ-10W	MS3CMX1240U-12W
Led brand	CREE	CREE COB
Led quantity	4pcs	1pc
Rated power	10W	12W
Lumen	650lm (±10%)	780lm (±10%)
Input voltage	DC24V/AC100-305V	AC100-264V
Frequency range	50/60Hz	50/60Hz
Color temperature	Single	Single
Beam angle	7 ~ 36° Photoelectron zoom	12° 24° 36°
Control method	DMX512	On/Off, DALi, 0-10V
Protection grade	IP66	IP66
Ambient temperature	-25°C~50°C	-25°C~50°C
Ambient humidity	10%~90%	10%~90%
Product life	50000H	50000H

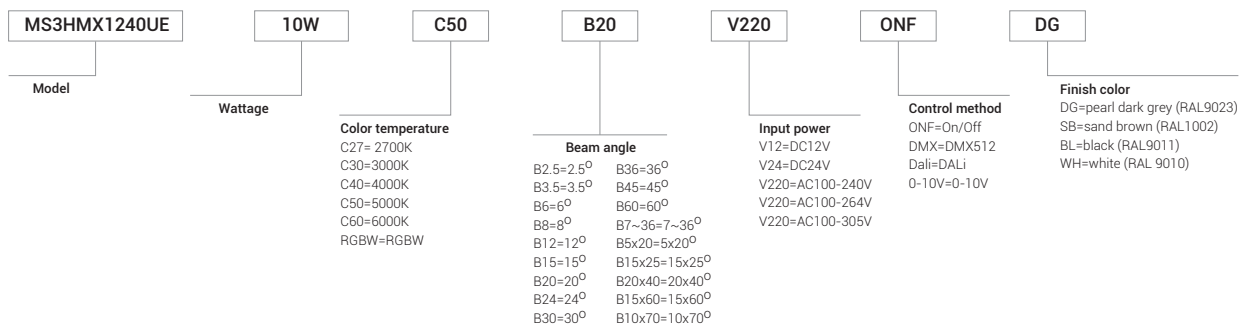
Typical order example

We reserve the right to make technical and design changes.

Date: 12-03-2021

THIEN MINH MECHANICAL - ELECTRIC JSC

Head office: MESTAR Building, No. 98/11 Ung Van Khiem Street, Ward 25, Binh Thanh District, Ho Chi Minh City, Vietnam.

Tel: (84) 28.3899 4790 - Email: mestar@mestar.vn - Web: www.mestar.vn

Ha Noi Office: TT4.18, Xuan Phuong Tasco Urban Area, Xuan Phuong Ward, Nam Tu Liem District, Hanoi City, Vietnam.

Tel: (84) 24.3222 2411



MATRIX 2

Accessories

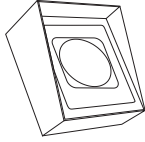

Anti-glare shield
MA-1240-AGS

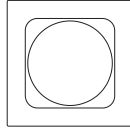

Square-meshed grill
MA-1240-SMG

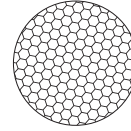

Honeycomb grill
MA-1240-HGR



Honeycomb glass
MA-1240-HGL

	MA-1240-AGS	MA-1240-SMG	MA-1240-HGR	MA-1240-HGL
MS3HMX1240UE-10W	•	•	•	•
MS3HMX1240UF-8W	•	•	•	•
MS3HMX1240UB-10W	•	•	•	•
MS3HMX1240UZ-10W	•	•	•	•
MS3HMX1240U-12W	•	•	•	•

Connection Accessories



Connector 3 pin - IP68
MA-M684-03



T Connector 3 pin - IP68
MA-M685T-03



Y Connector - IP68
MA-M685Y-03



Junction box 3 holes - IP68
MA-M686-03

