



PLATE 1

## FLOODLIGHTS



# PLATE 1



MODEL: **MS3HPL1262UB-36W**

## Introduction

PLATE 1 is rectangle surface architectural floodlight series, adopt isolate structure to fully ensure the stability and long lifespan of LED light. With multiway rotate function of u-shaped bracket mounting are available to meet various occasions demands for outdoor projects.

## Features

- High pressure die-casting aluminum housing.
- High strength toughened glass.
- Surface finish with fluorine carbon spraying ensuring high corrosion resistance, resist the impact and friction.
- LED module: high-power LEDs on metal-core PCB.
- High-efficiency PMMA lens with various beam angle option.
- Adopt American CREE original LED light source, high flux output, excellent consistency of color. NICHIA/LUMILEDS LED light source for asymmetric beam flood light option.
- Constant current AC100-240, driver with On/Off control method or DC24V input voltage with DMX512 control method.
- Single color with various temperature option: 2700K/3000K/4000K/5000K/6000K.
- Dynamic color with RGB option have gray level reach 65,536 degree equally make the light result is more beautiful.
- Powerful DMX512 interface adopt high reliable bus connect, all has the function of automatic addressing.

## Applications areas

- Facade of outdoor buildings, billboards, sculptures etc.

## Mounting type

- Surface mounting.

## Approvals and markings



## Feature



## Beam angle

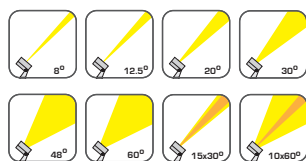

## Color temperature

- | Single  | Dynamic |
|---------|---------|
| • 2700K | • RGB   |
| • 3000K |         |
| • 4000K |         |
| • 5000K |         |
| • 6000K |         |

## Product color

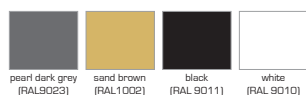

## Dimension (mm):

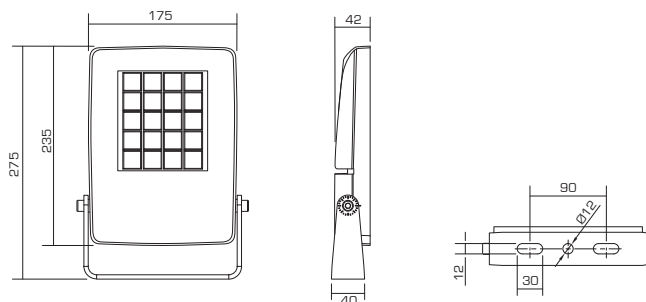

We reserve the right to make technical and design changes.

Date: 22-03-2021

THIEN MINH MECHANICAL - ELECTRIC JSC

Head office: MESTAR Building, No. 98/11 Ung Van Khiem Street, Ward 25, Binh Thanh District, Ho Chi Minh City, Vietnam.

Tel: (84) 28.3899 4790 - Email: mestar@mestar.vn - Web: www.mestar.vn

Ha Noi Office: TT4.18, Xuan Phuong Tasco Urban Area, Xuan Phuong Ward, Nam Tu Liem District, Hanoi City, Vietnam.

Tel: (84) 24.3222 2411



# PLATE 1

## Variants

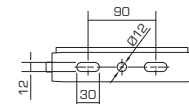
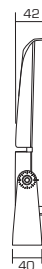
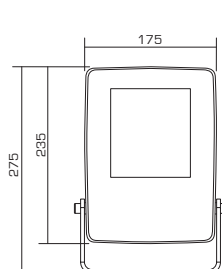
**MS3SPL1262UB-F-30W**

## Specification

Model	MS3HPL1262UB-36W	MS3HPL1262UB-30W	MS3HPL1262UB-22W	MS3SPL1262UB-F-30W
Led brand	CREE	CREE	CREE	NICHIA/LUMILEDS
Led quantity	20pcs	18pcs	12pcs	28pcs
Rated power	36W	30W	22W	30W
Lumen (RGB)	/	1200lm (±10%)	880lm (±10%)	/
Lumen (Single)	2340lm (±10%)	1950lm (±10%)	1430lm (±10%)	1950lm (±10%)
Input voltage	AC90-265V	DC24V	DC24V/AC90-265V	AC90-265V
Frequency range	50/60Hz	/	50/60Hz	50/60Hz
Color temperature	Single	RGB/Single	RGB/Single	Single
Beam angle	8° 12.5° 20° 30° 48° 60° 15x30° 10x60°			120x70°
Control method	On/Off	DMX512, On/Off	DMX512, On/Off	On/Off
Protection grade	IP66	IP66	IP66	IP66
Ambient temperature	-25°C~50°C	-25°C~50°C	-25°C~50°C	-25°C~50°C
Ambient humidity	10%~90%	10%~90%	10%~90%	10%~90%
Product life	50000H	50000H	50000H	50000H

## Typical order example

<b>MS3HPL1262UB</b>	<b>36W</b>	<b>C50</b>	<b>B20</b>	<b>V24</b>	<b>ONF</b>	<b>DG</b>
Model	Wattage 22W 30W 36W	Color temperature C27=2700K C30=3000K C40=4000K C50=5000K C60=6000K RGB=RGB	Beam angle B8=8° B12.5=12.5° B20=20° B30=30° B48=48° B60=60° B15x30=15x30° B10x60=10x60°	Input power V24=DC24V V220=AC90-265V	Control method ONF=On/Off DMX=DMX512	Finish color DG=pearl dark grey (RAL9023) SB=sand brown (RAL1002) BL=black (RAL9011) WH=white (RAL 9010)

We reserve the right to make technical and design changes.

Date: 22-03-2021

THIEN MINH MECHANICAL - ELECTRIC JSC

Head office: MESTAR Building, No. 98/11 Ung Van Khiem Street, Ward 25, Binh Thanh District, Ho Chi Minh City, Vietnam.

Tel: (84) 28.3899 4790 - Email: mestar@mestar.vn - Web: www.mestar.vn

Ha Noi Office: TT4.18, Xuan Phuong Tasco Urban Area, Xuan Phuong Ward, Nam Tu Liem District, Hanoi City, Vietnam.

Tel: (84) 24.3222 2411



# PLATE 1

## Accessories

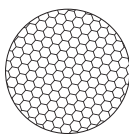

Honeycomb grill  
**MA-1262-HGR**



Anti-glare Shield  
**MA-1262-AGV**

MS3HPL1262UB-36W	•	•
MS3HPL1262UB-30W	•	•
MS3HPL1262UB-22W	•	•
MS3SPL1262UB-F-30W		•

## Connection Accessories



Connector 3 pin - IP68

**MA-M684-03**



T Connector 3 pin - IP68

**MA-M685T-03**



Y Connector - IP68

**MA-M685Y-03**



Junction box 3 holes - IP68

**MA-M686-03**

